

Fan Assisted Roof Light - 280

Installation and User Guide

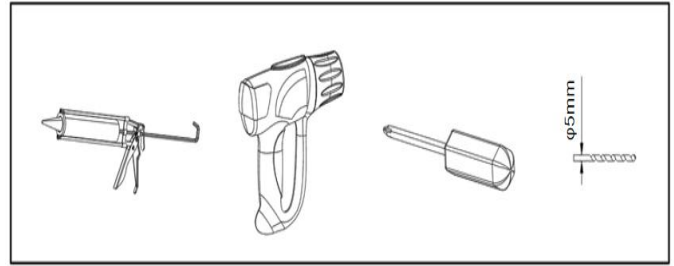

Product Code: AD282282-

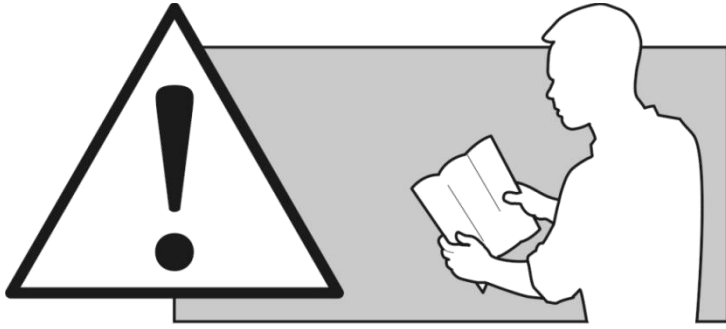

I. Spare part models based on wall

Wall thickness (H)	Screw	Worm gearing shaft	Inner frame	Knob
25- 40mm	4* 35	L=74mm	H=60mm	H=53mm
40- 50mm	4* 40	L=74mm	H=60mm	H=63mm
40- 80mm	4* 75	L=94mm	H=80mm	H=63mm

1. Worm gearing shaft

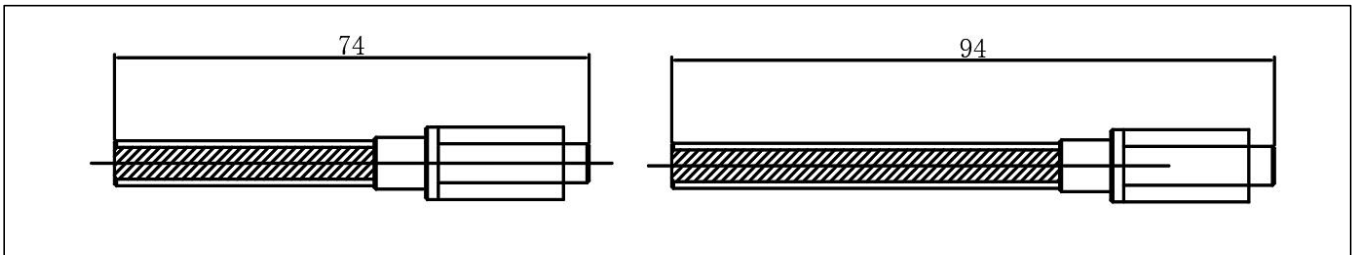

2. Inner frame

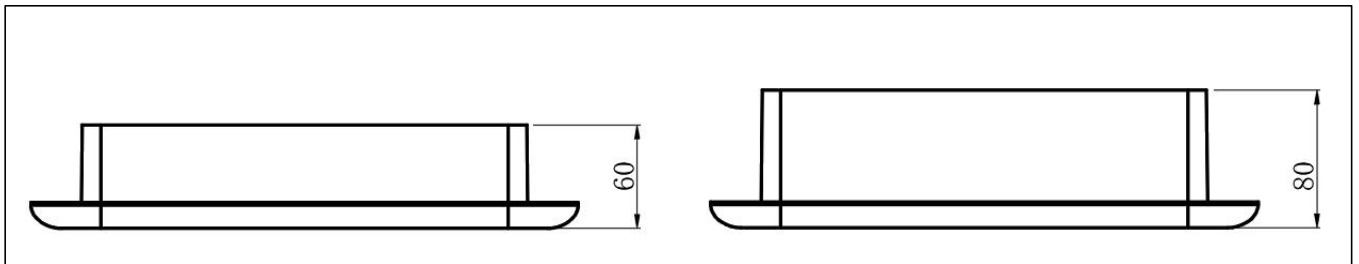

3. Knob

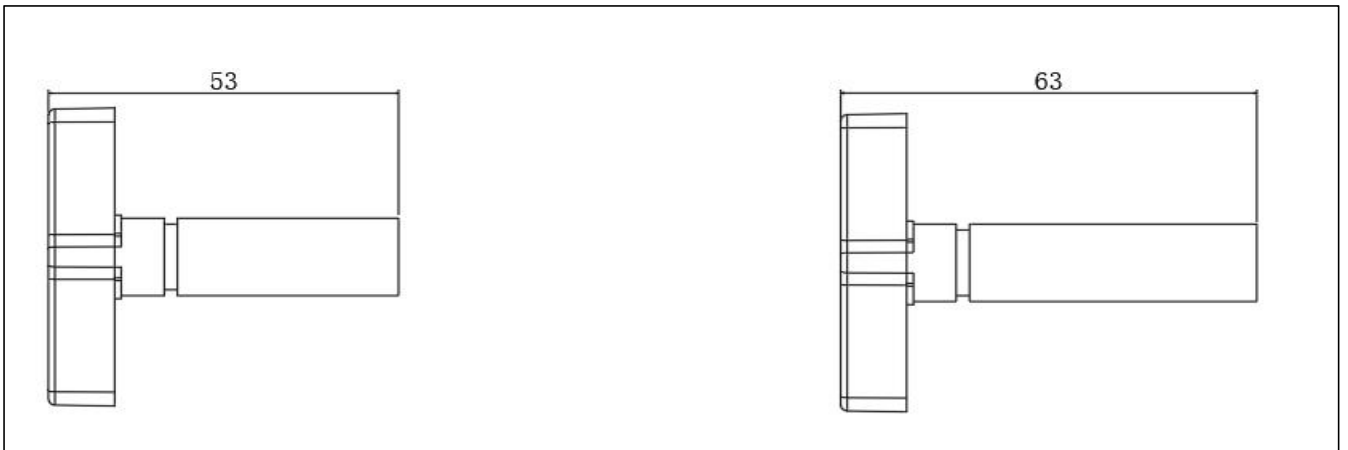

II. Performance

Voltage (V)	12V
Current (A)	0.25A
Power (W)	3W
Ventilating volume (CFM)	150CFM
Maximum opening angle (°)	≤50°
Overall size (mm)	363*358mm
Area of forced ventilation	160cm ²
Height above roof	85±2mm

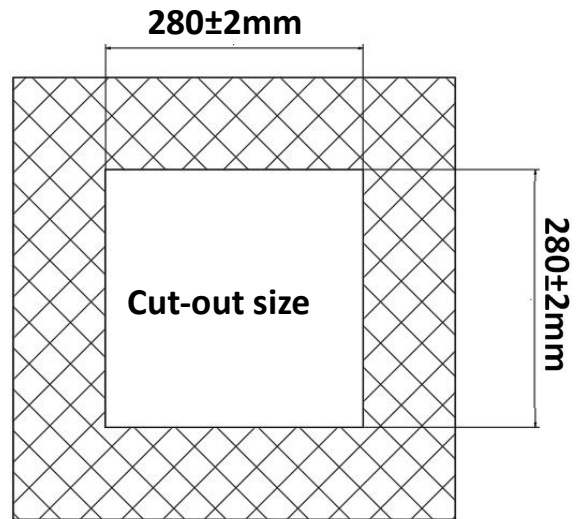

III. Steps of installation

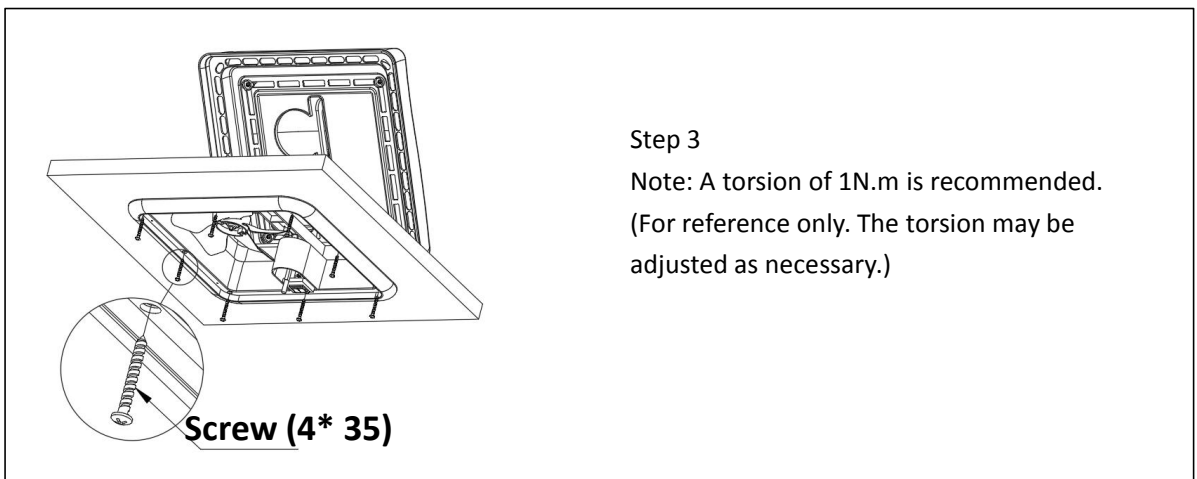
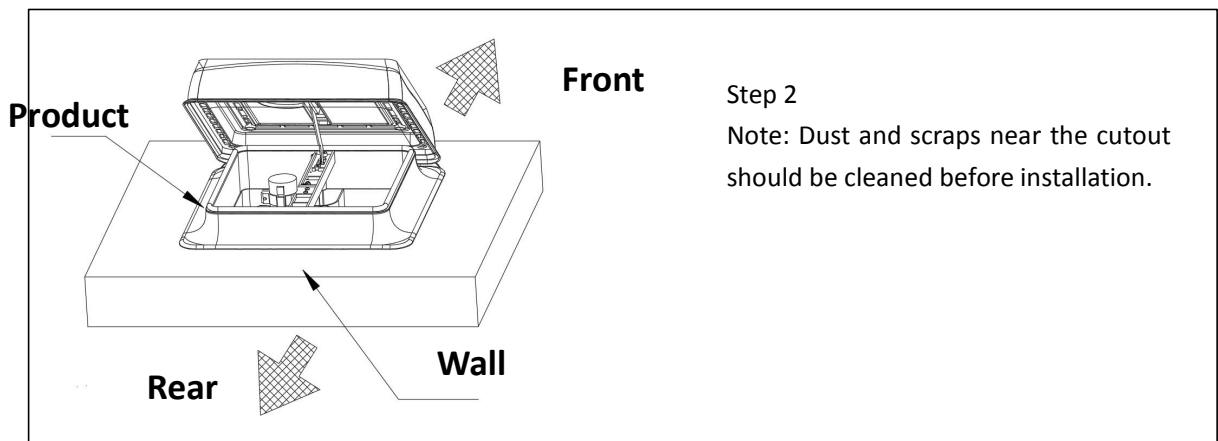
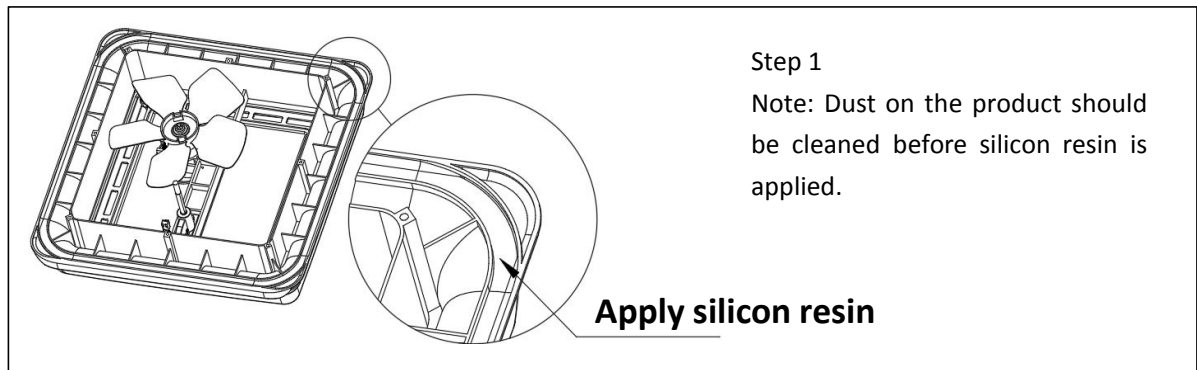

Step 4

Note: A torsion of 1N.m is recommended.
(For reference only. The torsion may be adjusted as necessary.)

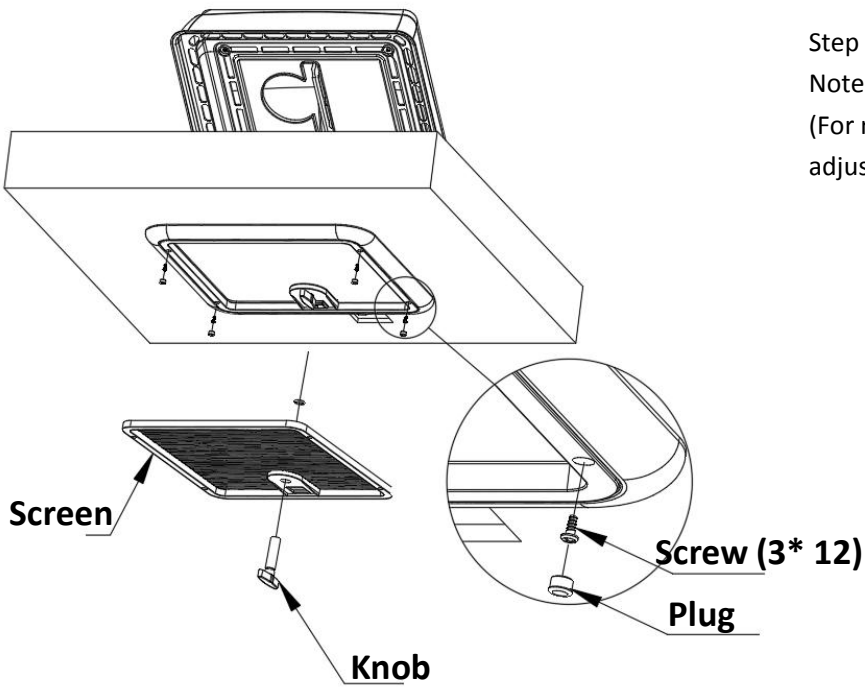

Installation completed

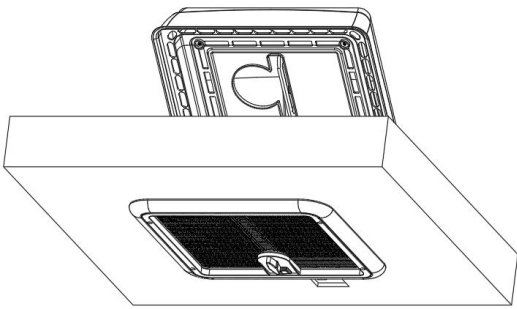
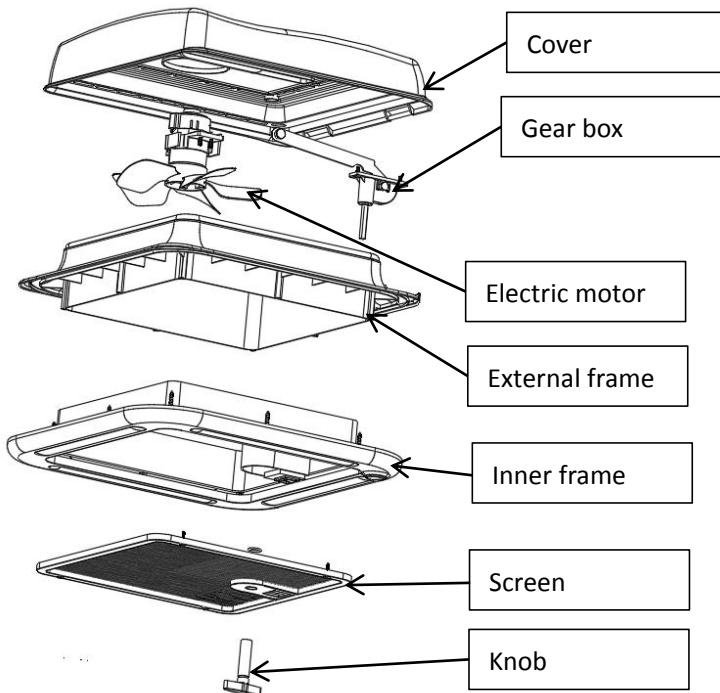

Diagram Replaceable parts



*** Operation and maintenance instructions**

- 1. If there is any problem with the product, please contact the dealer.**
- 2. Opening the cover: Turn the knob counterclockwise to open or clockwise to close the cover.**
- 3. Maximum open state: Fully open at 50°.**
- 4. LED lamp (round lamp) switch: Press “-” to turn on and “0” to turn off.**
- 5. Fan switch: LED lamp (round lamp) switch: Press “-” to turn on and “0” to turn off.**
- 6. Motor overheat protection temperature: 85°C.**
- 7. Check that the cover is closed when the vehicle runs or it rains, to prevent the product against damage.**
- 8. When cleaning the inner and outer frames of the ventilator, do not use any cleaning products, chemicals or polishing equipment. Only use water and soft cloth.**
- 9. Dust or debris on the ventilator can be removed with a dust remover. Do not use strong winds in case of damage to the product.**
- 10. The ventilator is designed to be rainwater proof. However, horizontal water flow with high pressure may harm the product.**